

Marvel-Schebler/Tillotson

Division Borg-Warner Corporation, 2195 South Elwin Road, Decatur, Illinois 62525

SERVICE BULLETIN

Sept. 1978

#A1-78

TO: All registered manual holders

SUBJECT: Improved retaining method for mixture control assembly on Model HA carburetors with rotary mixture control as illustrated:

TIME OF COMPLIANCE: At next inspection or as soon as possible, unless already installed.

A spring retainer has been added to subject model carburetor to counteract end play wear from vibration on the mixture control valve assembly, and retaining screw.

This retainer Part #55-A239 can be installed with the carburetor on the airplane.

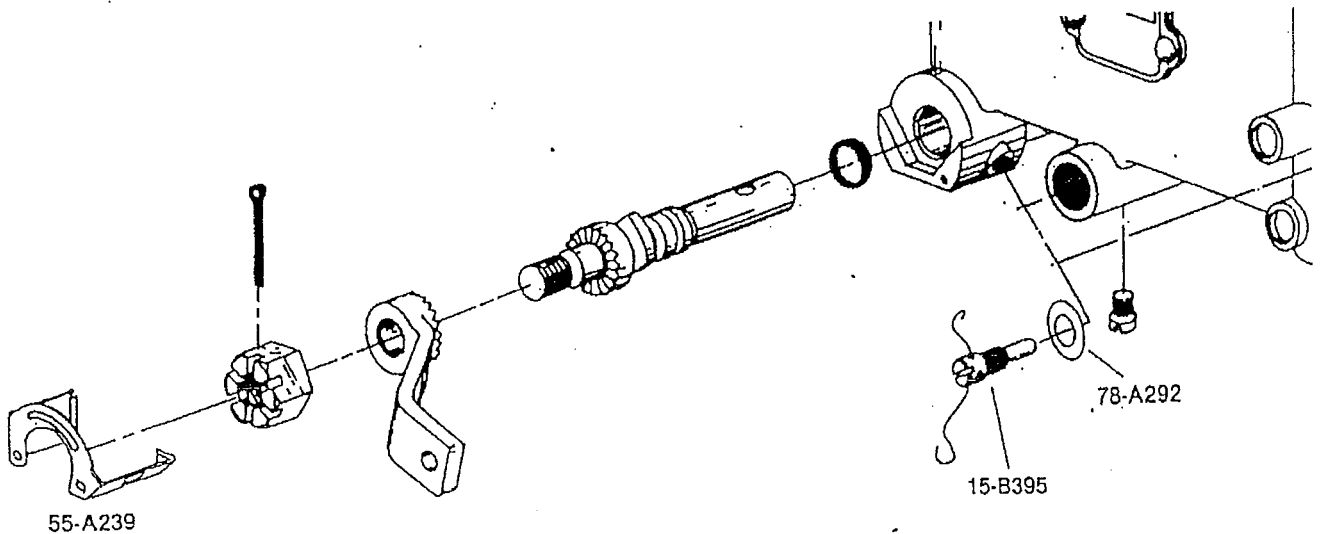

3 NEW PARTS

Additional Installation Instructions on Reverse Side



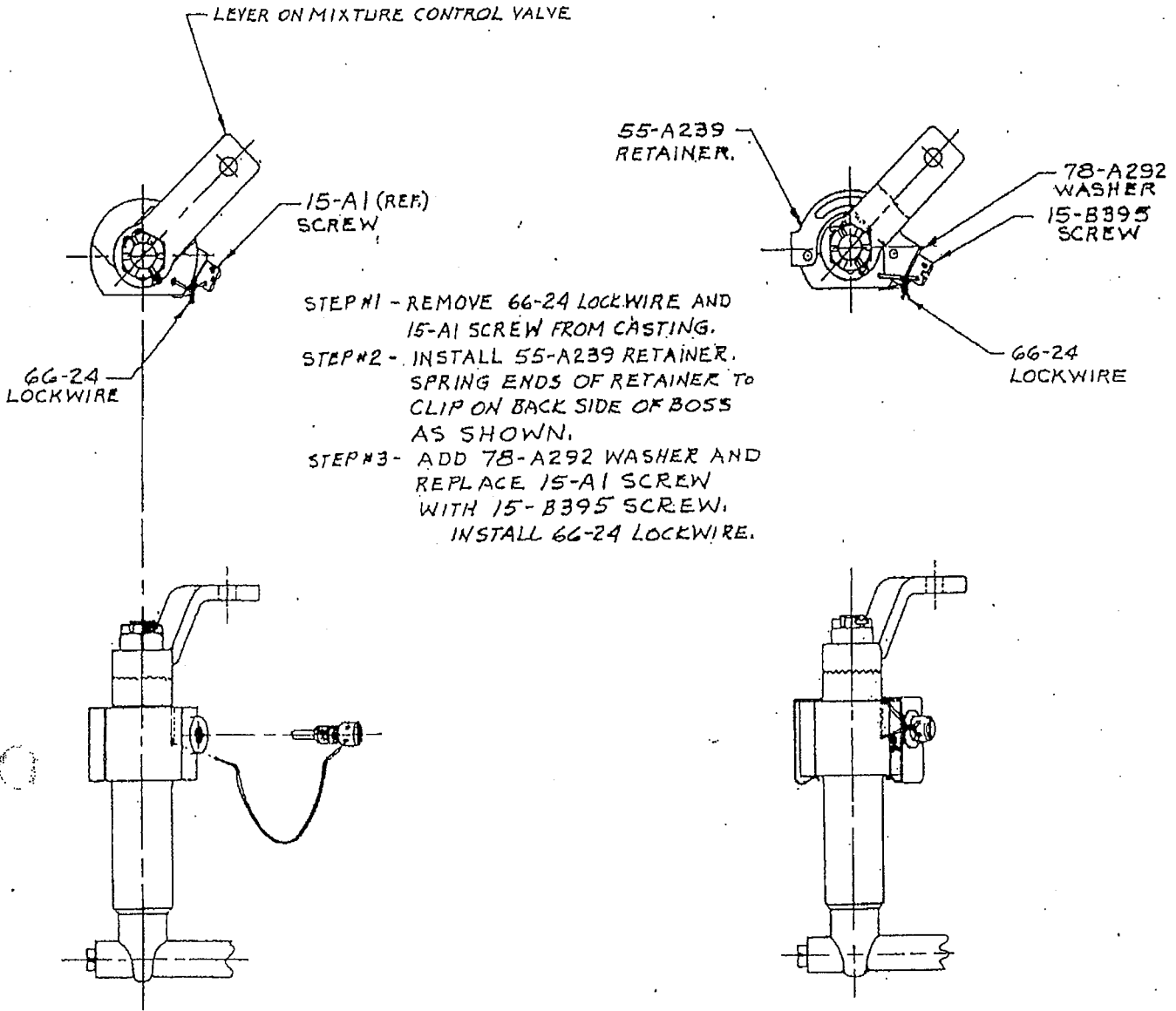

Lightly coat the tip of retaining screw
15-B395 with a silicone grease at assembly.

THREE NEW PARTS REQUIRED

		LIST PRICE
55-A239	MIXTURE CONTROL RETAINER.....	\$6.75
15-B395	SCREW MIXTURE CONTROL RETAINER.....	4.48
A292	WASHER MIXTURE CONTROL RETAINER.....	1.05